

PORCA SEXTAVADA TORQUE

ROSCA: UNC/UNF- ASME B1.1

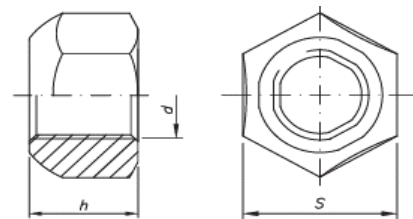

IFI - 100/107						
d Diâmetro	rosca/FPP		s (chave) Máx.		h (altura)	
			pol	mm	Mín.	Máx.
1/4	UNC-20	UNF-28	7/16	11,11	5,38	6,20
5/16	UNC-18	UNF-24	1/2	12,70	6,55	7,75
3/8	UNC-16	UNF-24	9/16	14,27	8,13	9,35
7/16	UNC-14	UNF-20	5/8	15,87	9,27	10,85
1/2	UNC-13	UNF-20	3/4	19,05	10,84	12,50
9/16	UNC-12	UNF-18	7/8	22,22	11,01	14,00
5/8	UNC-11	UNF-18	15/16	23,81	13,59	15,60
3/4	UNC-10	UNF-16	1-1/8	28,57	15,67	18,20
7/8	UNC-9	UNF-14	1-5/16	33,33	18,39	20,80
1"	UNC-8	UNF-12	1-1/2	38,10	21,11	23,00

ROSCA: Din 13

Din 980 (Din EN ISO 7042 • 10513)				
d Diâmetro	rosca/passos	s (chave)	h (altura)	
		Máx.	Mín.	Máx.
M6	MA-1,00	10	5,70	6,00
M8	MA-1,25	13	7,64	8,00
M10	MA-1,50	17	9,64	10,00
M12	MA-1,75	19	11,64	12,00
M14	MA-2,00	22	13,30	14,00
M16	MA-2,00	24	15,30	16,00
M18	MA-2,50	27	17,30	18,00
M20	MA-2,50	30	18,90	20,00
M22	MA-2,50	32	20,90	22,00
M24	MA-3,00	36	22,70	24,00