

PORCA SEXTAVADA PESADA - ASTM A194 - 2H

ROSCA: UNC/UN-ASME B1.1

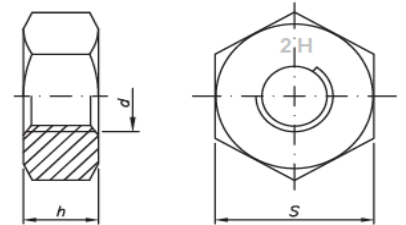

ASME B18.2.2				
d (Diâmetro)	rosca/FPP	h (altura)	s (chave) Máx.	
		Máx.	pol	mm
1/4	UNC-20	6,35	1/2	12,70
5/16	UNC-18	7,97	9/16	14,27
3/8	UNC-16	9,57	11/16	17,47
7/16	UNC-14	11,20	3/4	19,05
1/2	UNC-13	12,80	7/8	22,22
9/16	UNC-12	14,42	15/16	23,81
5/8	UNC-11	16,02	1-1/16	26,97
3/4	UNC-10	19,25	1-1/4	31,75
7/8	UNC-9	22,47	1-7/16	36,52
1"	UNC-8	25,70	1-5/8	41,27
1-1/8	UNC-7	28,93	1-13/16	46,02
1-1/4	UNC-7	31,77	2"	50,80
1-3/8	UNC-6	35,00	2-3/16	55,56
1-1/2	UNC-6	38,22	2-3/8	60,32
1-3/4	UNC-5	44,67	2-3/4	69,85
2"	UNC-4,5	51,13	3-1/8	79,37
2-1/4	UNC- 4,5	57,15	3-1/2	88,90
2-1/2	UNC-4	63,62	3-7/8	98,42
2-3/4	UNC-4	70,07	4-1/4	107,95
3"	UNC-4	76,53	4-5/8	117,47
1-1/8	UN-8	28,91	1-13/16	46,02
1-1/4	UN-8	31,77	2"	50,80
1-3/8	UN-8	35,00	2-3/16	55,56
1-1/2	UN-8	38,22	2-3/8	60,32
1-5/8	UN-8	41,45	2-9/16	65,07
1-3/4	UN-8	44,67	2-3/4	69,85
1-7/8	UN-8	47,90	2-15/16	74,62
2"	UN-8	51,13	3-1/8	79,37
2-1/4	UN-8	57,15	3-1/2	88,90
2-1/2	UN-8	63,62	3-7/8	98,42
2-3/4	UN-8	70,07	4-1/4	107,95
3"	UN-8	76,53	4-5/8	117,47
3-1/2	UN-8	89,05	5-3/8	136,52