

PORCA SEXTAVADA DUPLA

ROSCA: UNF/UNS- ASME B1.1

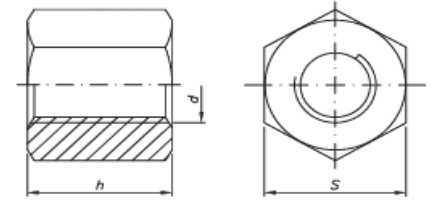

Padrão Comercial				
d Diâmetro	rosca/FPP	h (altura)	s (chave) Máx.	
		Máx.	pol	mm
3/8	UNF-24	12,14	9/16	14,27
7/16	UNF-20	15,84	5/8	15,87
1/2	UNF-20	15,97	3/4	19,05
9/16	UNF-18	19,73	07/ago	22,22
5/8	UNF-18	21,15	15/16	23,81
3/4	UNF-16	23,39	1-1/16	26,98
7/8	UNF-14	27,76	1-1/4	31,75
1"	UNS-14	33,75	1-1/2	38,10
1"	UNF-12	33,75	1-1/2	38,10
1-1/8	UNF-12	33,75	1-5/8	41,27
1-1/4	UNF-12	35,48	1-3/4	44,45

ROSCA: MB -Din 13 (ISO 965)

Padrão Comercial			
d Diâmetro	rosca/ passo	h (altura)	s (chave)
		Nom.	Máx.
M10	MB-1,00	14,00	19
M12	MB-1,50	16,00	19
M14	MB-1,50	19,00	22
M16	MB-1,50	21,00	24
M18	MB-1,50	23,00	27
M20	MB-1,50	27,00	30
M22	MB-1,50	27,00	32
M24	MB-2,00	30,50	36
M30	MB-2,00	36,00	46